

Ampatex® DB 90

Vapour check and airtight layer



- > Standard for roof and wall constructions
- > Compatible with all conventional heat insulation materials
- > Keeps its shape
- > Can be used anywhere
- > Does not attract dust

Technical details		Value	Standard
s _D value		20m	EN 1931
Weight		90g/m ²	EN 1849-2
Tear resistance	longitudinal	160 N/5cm	EN 12311-2/A
	transverse	160 N/5cm	
Tear elongation	longitudinal	30%	EN 12311-2/A
	transverse	30%	
Resistance to further tearing (nail shaft)	longitudinal	200 N	EN 12310-1
	transverse	200 N	
Fire behaviour		E	EN 13501-1
Fireclass		5.2	VKF
Waterproofing (at 2 kPa)		passed	DIN EN 1928
Width of overlap		10cm	
Straightness		<75mm/10m	EN 1848-2
Temperature resistance		-40 to +80 °C	
Water vapour resistance after ageing		passed	EN 1296, 70 °C EN 1931



Areas of application: The safe alternative to all polythene films.

Forms of delivery			
Article number	Description	Roll dimensions	Content of pallets
7640115530783	Ampatex® DB 90	1,5m × 100m = 150m ²	25 rolls = 3750m ²
7640115533630	Ampatex® DB 90 with 120m Ampacoll® INT	1,5m × 100m = 150m ²	25 rolls = 3750m ²
7640115535917	Ampatex® DB 90 short roll with 30m Ampacoll® INT	1,5m × 25m = 37,5m ²	50 rolls = 1875m ²
7640115535443	Ampatex® DB 90	3,0m × 50m = 150m ²	24 rolls = 3600m ²
7640115535894	Ampatex® DB 90 with 60m Ampacoll® INT	3,0m × 50m = 150m ²	24 rolls = 3600m ²

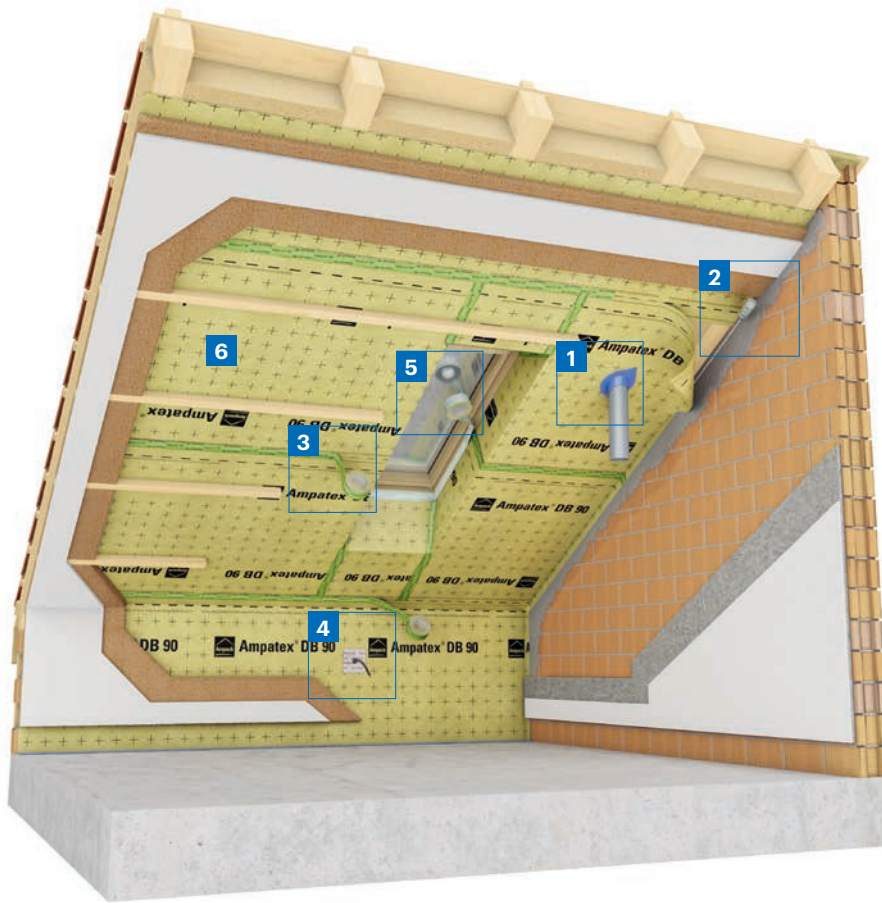

6 Ampatex® DB 90
Vapour check



Processing tips

Ampatex® DB 90 is both a vapour check and an air seal. All joints, gaps, overlaps, connections and openings must be hermetically sealed. Surface damage must be sealed. In dry interiors, **Ampatex® DB 90** should be used on the warm side of the heat-insulating layer, and in areas where there is an overlap it should be fastened with concealed staples or nails. The smooth, printed side faces into the room and this is the surface onto which the next product should be taped. When laying, make sure that the strips overlap by 10 cm. The over-

laps should then be completely covered with the **Ampacoll® INT** supplied. **Ampacoll® DT** adhesive tape is useful where the underlying material cannot be nailed. Finally the lining on the inside is fixed in place. **Ampacoll® BK 530** or **Ampacoll® RA** are used for edge connections. Porous or dusty surfaces should be pretreated with **Ampacoll® Primax**. Penetrations such as ventilation pipes, conduits, purlins, rafters, etc. should be permanently sealed with **Ampacoll® BK 535**, 50 mm wide. With porous, dusty or rough surfaces, a

pretreatment of **Ampacoll® Primax** is also required.



Note the application guidelines and other system products in our adhesive matrix



For more detailed information and documents see www.ampack.biz

Sales through dealers

Ampack Swiss: 071 858 38 00
Ampack Austria: 05523 53433
Ampack Germany: 07621 1610264
Ampack France: 04 50 83 70 54
Ampack Italy: 0471 053 475

www.ampack.biz



This data may become invalid as a result of new information or development. Current information can be found at www.ampack.biz. © Ampack AG, Rorschach, 05.2018

4110EU/EX.YY-(VS)102017