

Ampatop® SealEdge Ampatop® SealEdge GHS Eaves membrane



Application tips





> Prefabricated combination of **Ampatop® Seal** or **Ampatop® Seal GHS** with a highly UV-resistant PVC strip

> Can be solvent welded or hot welded

1 Ampatop® SealEdge

2 Ampatop® SealEdge GHS

external

Area of application:

The **Ampatop® SealEdge** or **Ampatop® SealEdge GHS** is a prefabricated eaves membrane with factory welding of a UV-resistant PVC strip to the roof membrane **Ampatop® Seal** or **Ampatop® Seal GHS**. The product is used to seal open eaves with perforated metal to drain water from the roof membrane into the gutters.

Ampatop® SealEdge GHS: With seal of quality from "Gebäudehülle Schweiz" association.

Technical details		Value	
Weight	Ampatop® Seal or Ampatop® Seal GHS		350 g/m ²
	PVC strip		650 g/m ²
Width	Ampatop® Seal or Ampatop® Seal GHS		300 mm
	PVC strip		300 mm
Tensile strength	Ampatop® Seal or Ampatop® Seal GHS PVC strip	lengthwise	350
		crosswise	380 N/5 cm
		lengthwise	2800
		crosswise	2500 N/5 cm
Welding temperature	Ampatop® Seal or Ampatop® Seal GHS PVC strip		240–280 °C
			280 °C
UV stability	Ampatop® Seal Ampatop® Seal GHS PVC strip		3 months
			6 months
			>10 years
Abrasion resistance	Ampatop® Seal GHS		passed (GHS)
Hail resistance	Ampatop® Seal GHS		HW4 passed (GHS)

Available as

Item no.	Product name	Roll size
7640115536945	Ampatop® SealEdge	600 mm × 30 m
7640442090752	Ampatop® SealEdge GHS	600 mm × 30 m



Conditions for the twenty-year premium warranty include registering the building object and the Ampack products used. In addition, our products must be used as part of a system. For further details, please see our General Warranty Conditions.

ISO 9001
Swiss Research

CE
13984

Application



Note

If the roof membrane is drained into the gutters, make sure that the eaves flashing is wide enough to prevent any exposure of the membrane and its seal to UV light.

If this is not possible, the area can be finished with our UV-resistant **Ampatop® SealEdge** or **Ampatop® SealEdge GHS**.

- 1 Connection to eaves flashing with **Ampacoll® DoubleSeal** (double) or **Ampacoll® Profix** (single)
- 2 Nail seals **Ampacoll® ND.Band** or **Ampacoll® ND Duo** (for roof pitch <math><25^\circ</math> and/or altitude >800m above sea level).

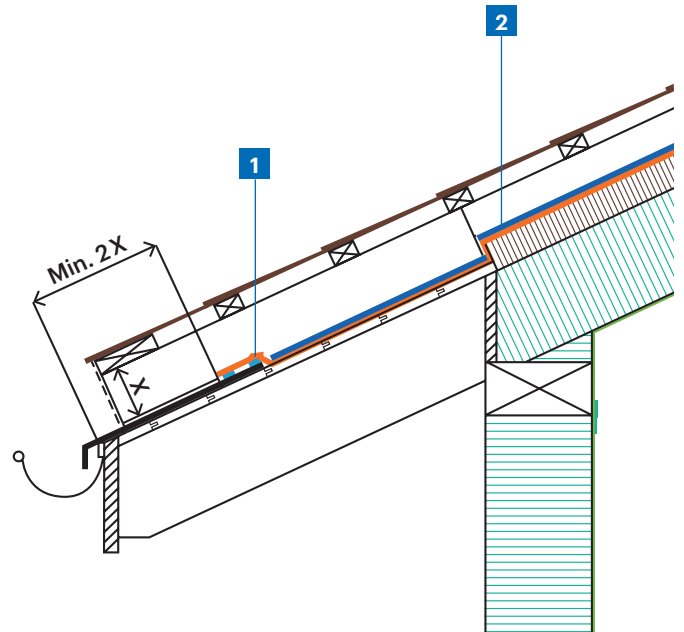

Application:

There are two options for bonding **Ampatop® SealEdge** or **Ampatop® SealEdge GHS** to the inlet sheet:

- > Clean the bonding area of the bottom layer of **Ampatop® SealEdge** or **Ampatop® SealEdge GHS** and the eaves flashing with a cloth lightly moistened with **Ampacoll® LiquiSeal** and apply two strips of **Ampacoll® DoubleSeal** double-sided adhesive tape in a rainproof manner to the inlet sheet.
- > Apply **Ampacoll® Profix** as an approx. 8mm thick bead to the inlet sheet and insert the **Ampatop® SealEdge** or **Ampatop® SealEdge GHS** into the **Ampacoll® Profix** and rub gently. Minimum thickness of finished adhesive bead: 2mm. In areas where backwater or backswell water is to be expected, make two beads (e.g. internal gutter).

Please observe the corresponding installation instructions when using **Ampatop® Seal** or **Ampatop® Seal GHS**.

- 1 Connection to eaves flashing with **Ampacoll® DoubleSeal** (double) or **Ampacoll® Profix** (single)
- 2 Prefab welded seal
- 3 On-site welding with **Ampacoll® LiquiSeal** or hot air
- 4 Nail seals **Ampacoll® ND.Band** or **Ampacoll® ND Duo** (for roof pitch <math><25^\circ</math> and / or altitude >800m above sea level).

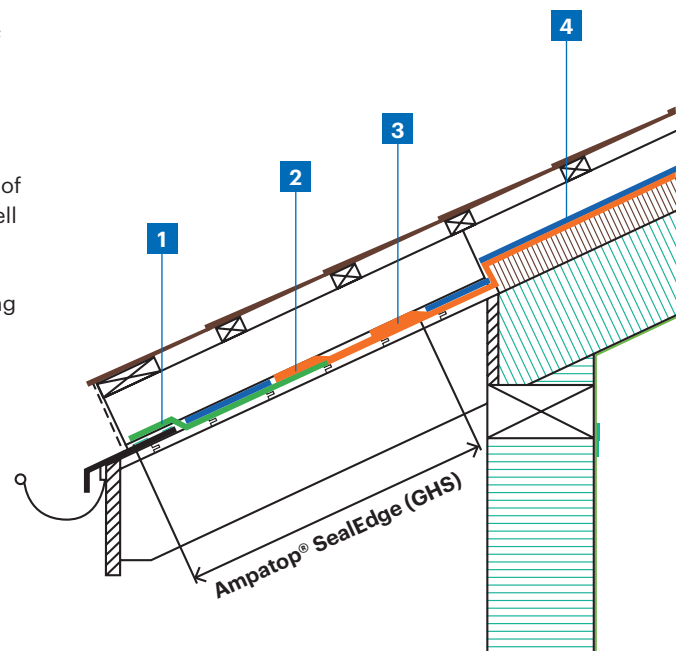

Please observe the recommendations for use and further system products in our adhesives matrix



Further information and detailed documentation at www.ampack.biz

The building shell experts. Since 1946.

Ampack AG
Sebleichstrasse 50
CH-9401 Rorschach
T +41 (0)71 858 38 00
F +41 (0)71 858 38 37
ampack@ampack.ch
www.ampack.biz

