

Sisalex® 303



Paper vapour check and airtight layer



- Ecological product: all components of natural origin
- Stable and tear-resistant grid of glass fibres
- No fungicidal coating
- Three layers: two plies of kraft paper and a glass-fibre mesh insert

Technical details		Value	Standard
Product name		Type B	EN 13984:2013
s _D value		5 m	EN 1931
Weight per unit area		180 g/m ²	EN 1849-2
Tear resistance	longitudinal	490 N/5 cm	EN 12 311-2/ A
	transverse	230 N/5 cm	
Elongation at break	longitudinal	3 %	EN 12 311-2/ A
	transverse	6 %	
Resistance to tearing (nail shank)	longitudinal	60 N	EN 12 310-1
	transverse	45 N	
Fire behaviour		E	EN 13 501-1
Watertightness at 2 kPa		passed	DIN EN 1928
Width of overlap		10 cm	
Straightness		< 75 mm/10 m	EN 1848-2
Temperature resistance		-40 to +80°C	
Water vapour resistance after ageing		passed	EN 1296, 70 °C, EN 1931
Dangerous substances		none	
Visible defects		none	EN 1850-2

10

Jahre Garantie
Ans Garantie
Anni Garanzia
Years Warranty

Security is part of the system at Ampack. We not only cover the cost of the materials, but also the installation and removal costs.



Delivery forms			
Item no.	Identification	Roll size	Pallet contents
7640115530707	Sisalex® 303	1,5 m × 50 m = 75 m ²	42 rolls = 3,150 m ²
7640115535726	Sisalex® 303	3,0 m × 50 m = 150 m ²	16 rolls = 2,400 m ²

1 Ampacoll® BK 535
butyl rubber strip

Sisalex® 303
vapour check

2 Ampacoll® RA
liquid adhesive

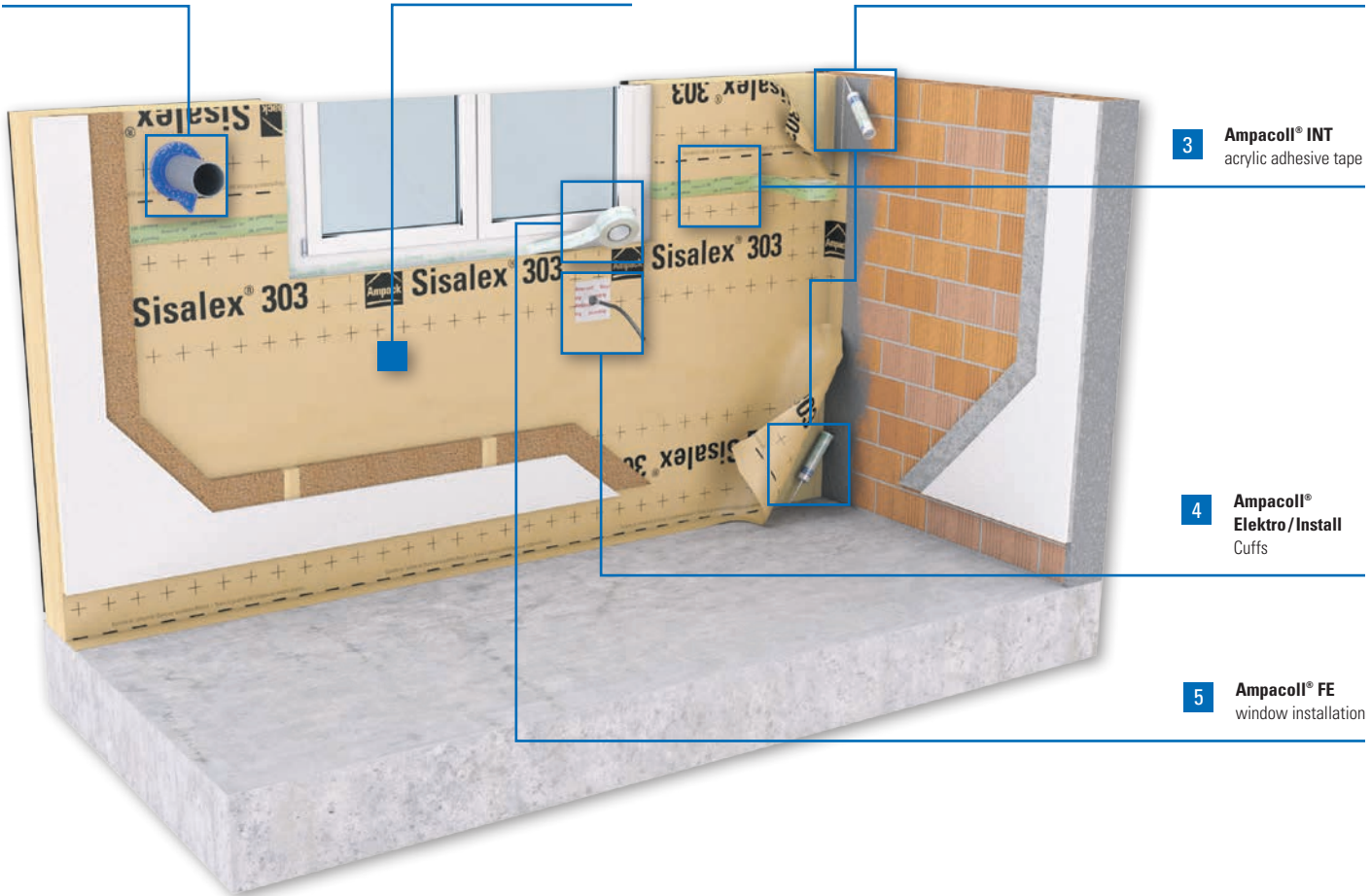

3 Ampacoll® INT
acrylic adhesive tape

4 Ampacoll®
Elektro/Install
Cuffs

5 Ampacoll® FE
window installation



1 Ampacoll® BK 535:
Butyl rubber strip



2 Ampacoll® RA:
Liquid adhesive



3 Ampacoll® INT:
Acrylic adhesive tape



4 Ampacoll® Electro a.
Install: Cuffs



5 Ampacoll® FE: window
installation tape



Applications tips

Sisalex® 303 is applied as an airtight layer and vapour check for dry interior finishing and positioned on the warm side of the thermal insulation where it is stapled to the construction. Take care when positioning it that the membranes overlap by 10 cm and that the joints are tightly sealed with the enclosed

system adhesive strip **Ampacoll® INT**. **Ampacoll® DT** acrylic tape represents an installation aid on underlying structures that cannot be nailed. Application of the interior lining serves as the final fastening step. Edge connections must be sealed with **Ampacoll® BK 530** or **Ampacoll® RA**. Porous or dusty

surfaces must be pre-treated with **Ampacoll® Primax**. Penetrations such as ventilation and electric pipes must be permanently sealed with **Ampacoll® BK 535** (50mm). Use **Ampacoll® Primax** as a primer on porous, dusty or rough surfaces.



Please observe the recommendations for use and further system products in our adhesives matrix



Further information and detailed documentation at www.ampack.biz

Sales via specialist dealers

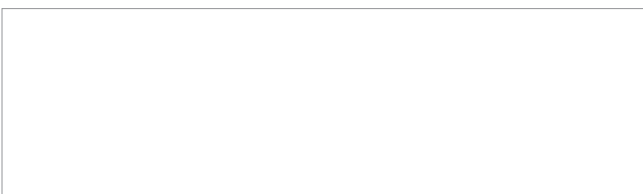

The following information could have been superseded by new findings or developments. Up-to-date information can be found at www.ampack.eu © Ampack AG

4108EU/EX.YY(VS)1017

www.ampack.biz
 Ampack Switzerland: 071 858 38 00
 Ampack Austria: 05523 53433
 Ampack Germany: 07621 1610264
 Ampack France: 04 50 83 70 54
 Ampack Italy: 0471 053 475

